

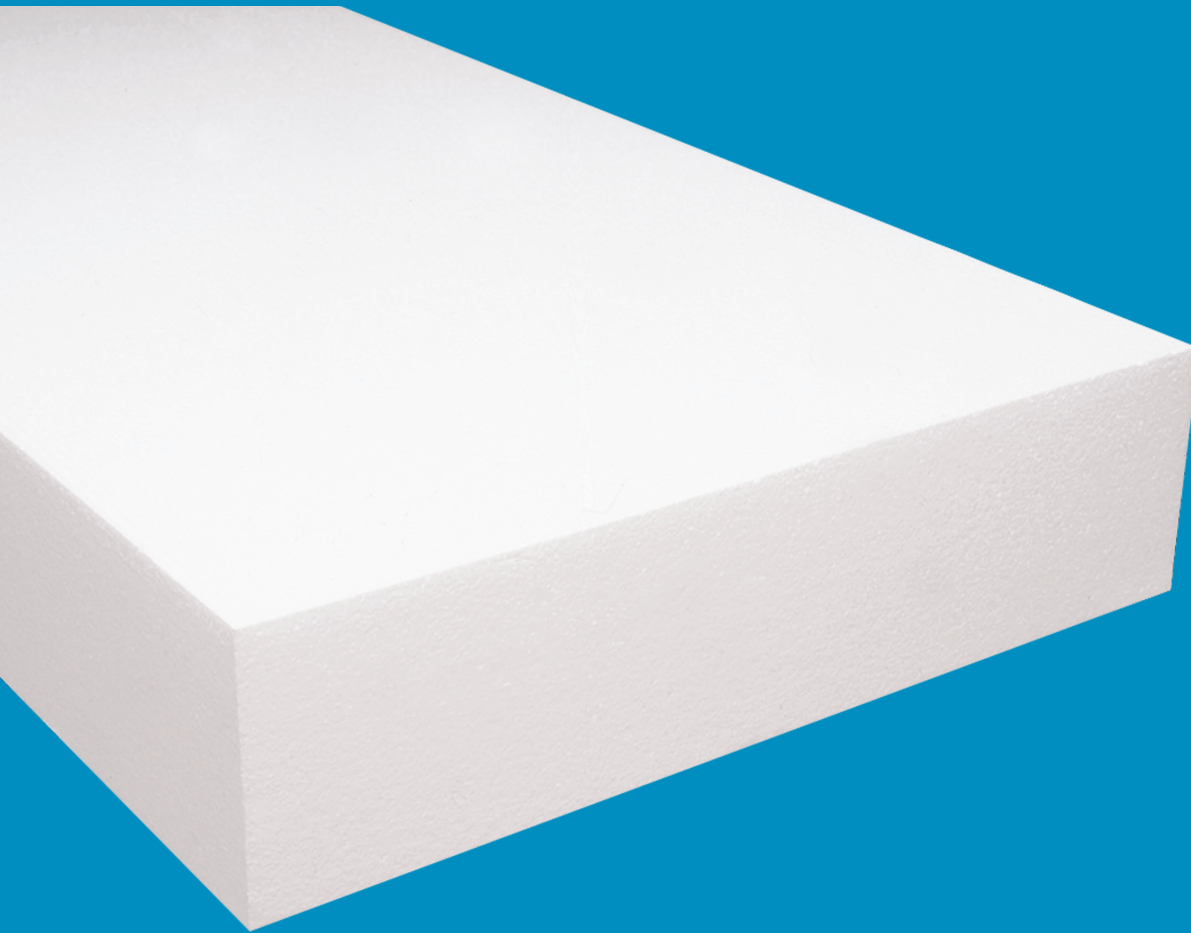

HAWAII CONSTRUCTION FOAM

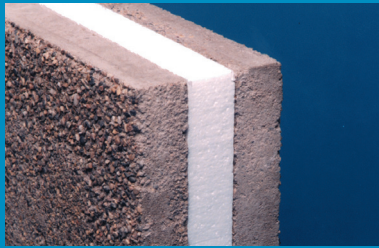

PACIFIC ALLIED PRODUCTS Ltd
MANUFACTURING PACKAGING SOLUTIONS FOR HAWAII



**MOLDED
POLYSTYRENE
INSULATION**

HAWAII CONSTRUCTION FOAM PERFORMS IN ALL APPLICATIONS

From Frost Line to Roof Line.

Hawaii Construction Foam is used in a wide range of critical insulation applications: Perimeter, Underslab, Cavity Wall, Wall Sheathing, Precast Concrete Core, Flat/Tapered Roofing, Vegetative Green Roof, Plaza Deck, Drainage Board, and Waterproofing Protection. All of these applications benefit from the exceptional physical properties and wide range of board thicknesses, sizes, and options available with Hawaii Construction Foam.

Hawaii Construction Foam is engineered to give you the greatest possible control over your project application: from design and timelines, to material cost, and ultimately, control over your results.

- Perimeter/Underslab
- Cavity Wall
- Wall Sheathing
- Precast Concrete Core
- Flat/Tapered Roofing
- Plaza Deck/Vegetative Green Roof
- Drainage Board
- Waterproofing Protection

With Hawaii Construction Foam, you're in control of your materials.

Strength/R-value.

|  HAWAII CONSTRUCTION FOAM | Compressive Strength ¹ , psi | R-value/inch ² | |
|---|---|---------------------------|------|
| | | 75°F | 40°F |
| 100 | 10 | 3.9 | 4.2 |
| 130 | 13 | 3.9 | 4.3 |
| 150 | 15 | 4.2 | 4.6 |
| 250 | 25 | 4.4 | 4.8 |
| 400 | 40 | 4.4 | 4.8 |
| 600 | 60 | 4.5 | 4.9 |

¹ Compressive strength @ 10% deformation.
² R-value units are °F-ft²-h/Btu.

Hawaii Construction Foam is available in a wide range of R-values and thicknesses to meet your needs. Project requirements vary, so Hawaii Construction Foam can be ordered in any R-value thicknesses to meet your needs.

Proven to meet, or exceed, building codes.

Hawaii Construction Foam is manufactured under an industry leading quality control program monitored by UL and further recognized in UL Evaluation Report UL ER40267-01. Hawaii Construction Foam meets ASTM C578, “Standard Specification for Rigid, Cellular Polystyrene Thermal Insulation”.



Sustainability.

Hawaii Construction Foam reduces energy use in buildings, helping protect our environment. Well insulated buildings perform better and improve the environment. Life Cycle Analysis (LCA) has shown significant energy savings and substantial reductions in greenhouse gas emissions with the use of Hawaii Construction Foam.

The use of Hawaii Construction Foam in building construction helps earn credits for green building initiative programs, such as LEED Certification. Hawaii Construction Foam does not use ozone depleting blowing agents and is recyclable.

Fifty year R-value warranty, regardless of thickness or application – the warranty covers it!



Recyclable.

After it's life as a building insulation, Hawaii Construction Foam is 100% recyclable. It can be ground into granules and reincorporated into new Hawaii Construction Foam products. Or it can be thermally processed into a resin that's used to manufacture other new products.

Hawaii Construction Foam

Molded Polystyrene Insulation.

Hawaii Construction Foam molded polystyrene insulation is a cost-effective, durable, and energy efficient solution. Hawaii Construction Foam is an insulation manufactured to provide architects, specifiers, distributors, and contractors all the features and benefits inherent in a high quality insulation.

Stable R-value – Hawaii Construction Foam has a R-value that never changes over time.

Strength – Hawaii Construction Foam comes in compressive strengths of 10, 13, 15, 25, 40, and 60 psi.

Moisture Resistance – Hawaii Construction Foam is a closed cell polystyrene insulation and is resistant to moisture gain.

Vapor Permeable – Hawaii Construction Foam allows moisture vapor to move through its structure.

Drying Potential – Hawaii Construction Foam rapidly releases absorbed moisture.

When you consider all performance characteristics and cost, Hawaii Construction Foam is your best choice for foam insulation.

Performance Value.

Hawaii Construction Foam has air in its closed cells and therefore has a stable R-value. Many other insulations use blowing agents that cause R-value loss and are harmful to the environment.

Hawaii Construction Foam has compressive strength to meet specific project requirements.

Hawaii Construction Foam is manufactured to resist moisture absorption in wetting conditions and release absorbed moisture quickly during drying periods, which means Hawaii Construction Foam maintains R-value.

Termite Resistant.

One of the most destructive forces anywhere is termites. Hawaii Construction Foam can be manufactured with borate, a proven and safe additive, that effectively resists termites.

Hawaii Construction Foam with borate meets ICC ES AC239, "Acceptance Criteria for Termite-Resistant Foam Plastics".

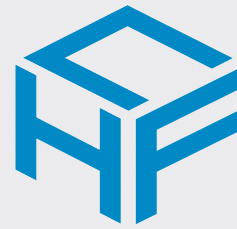

HAWAII CONSTRUCTION FOAM

FOAM FACTS:

Hawaii Construction Foam outperforms XPS.

- Hawaii Construction Foam provides a stable long-term R-value at a lower cost
- Hawaii Construction Foam uses a blowing agent with 10 x lower global warming potential and 10,000 x lower ozone depletion
- Hawaii Construction Foam meets strength requirements at a lower cost
- Hawaii Construction Foam and XPS have resistance to moisture, but Hawaii Construction Foam has a higher vapor permeance leading to superior drying potential
- Hawaii Construction Foam with borate treatment available to provide termite resistance

Product Availability and Support.

Hawaii Construction Foam Insulation is supported by a team of experts who work with you to answer your questions, offer solutions, and do everything they can to make sure your project goes smoothly and ends successfully.

Ready to take control? Start here.

If you're ready to have Hawaii Construction Foam contribute to your next project, just contact your nearest Hawaii Construction Foam Insulation manufacturer and Technical Sales Representative. We will be happy to give you design consultation, information about Hawaii Construction Foam products, pricing, and answers to all of your questions.



PACIFIC ALLIED PRODUCTS Ltd.
MADE IN HAWAI'I, FOR HAWAI'I SINCE 1965

91-110 KAOMI LOOP
KAPOLEI, HI, USA, 96707
808-682-2038 MAIN PHONE
808-682-4759 MAIN FAX
888-824-3626 MAIN TOLL FREE